

STEP 1

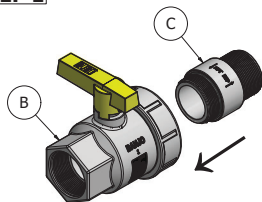

Ensure Banjo Valve (B) is in CLOSED position to prohibit liquids from flowing. Attach 2" NPT end (shorter threaded end) of Nipple (C) to Banjo Valve's round end.

STEP 2

Prepare container by removing plastic safety seal from liner decant fitment. Unscrew decant plug from fitment.

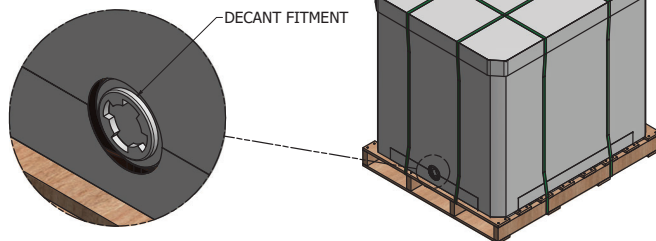

LAPOINT HYBRID LIQUID IBC BANJO VALVE INSTRUCTIONS

BANJO VALVE ASSEMBLY COMPONENTS LIST			
ITEM	QTY	P/N	DESCRIPTION
A	1	102302	CAMLOCK ADAPTER: 2" MALE X 2" NPT FEMALE, FDA, POLYPROPYLENE
B	1	102243	BANJO VALVE: 2" NPT FEMALE INLET & OUTLET, FDA, POLYPROPYLENE
C	1	102242	NIPPLE: 2" BSP MALE X 2" NPT MALE, FDA, POLYPROPYLENE

CROWN CUTTER, METHOD A

STEP 3A

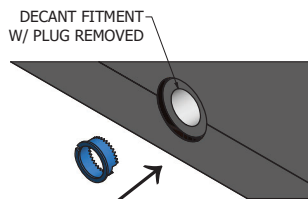

Remove blue crown cutter from decant fitment. Reinsert cutter into decant fitment with spiked edge facing liner.

STEP 4A

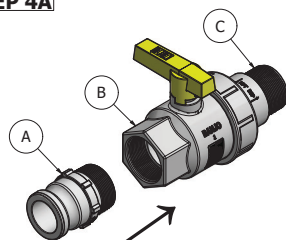

Attach Camlock Adapter (A) or sanitary fitment to hexagonal end of Banjo Valve (B). Keep valve in CLOSED position.

STEP 5A

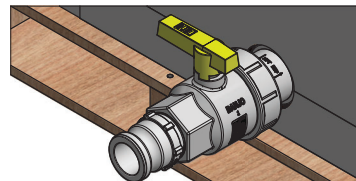

Insert Banjo Valve assembly into decant fitment. Before threading, turn Banjo Valve counter-clockwise two (2) turns to ensure straight connection. Thread assembly into decant fitment by turning clockwise and tighten to rubber seal.

STEP 6A

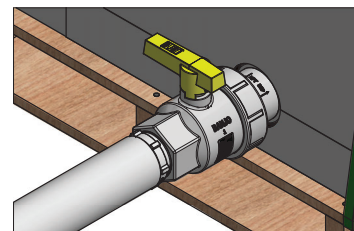

Attach any hoses or equipment needed to Camlock Adapter (A) or sanitary fitment.

STEP 7A

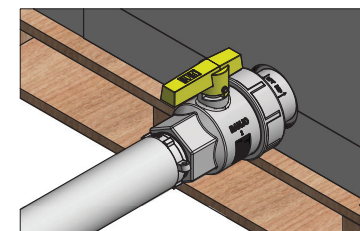

Open valve to allow product flow.

PLUNGE CUTTER, METHOD B

STEP 3B

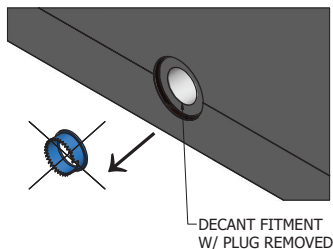

Remove enclosed blue crown cutter from decant fitment and discard.

STEP 4B

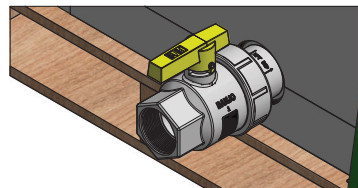

Insert Banjo Valve assembly into decant fitment. Before threading, turn the Banjo Valve counter-clockwise two (2) turns to ensure straight connection. Thread assembly onto decant fitment by turning clockwise and tighten to rubber seal. Turn valve to OPEN position.

STEP 5B

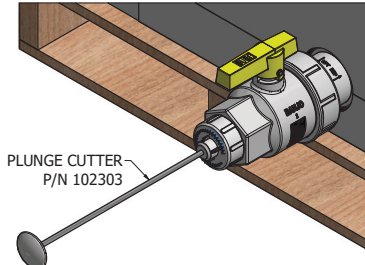

Attach Plunge Cutter and pierce liner. Retract plunger and CLOSE valve before detaching plunge cutter.

STEP 6B

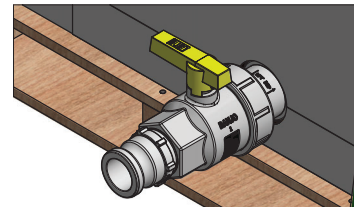

Attach Camlock Adapter (A) or sanitary fitment to V-50 valve (B) outlet.

STEP 7B

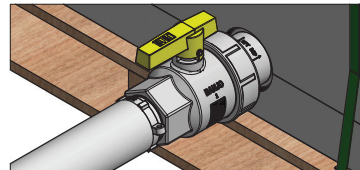

Attach any hoses or equipment needed to Camlock Adapter (A) or sanitary fitment. Open valve to allow product flow.



LAPOINT PACKAGING at PackGen
160 Cascades Drive
Auburn ME 04210
(207) 784-4195
www.lapointpackaging.com
sales@packgen.com